

ONE-CARETM PRO

SAFETY LANCETS



Blood microsampling has never been easier ...

Ergonomic

Ergonomic T-Shape body for convenient grip

Easy

Long cap for easy twist off and pull out

Comfortable

Dual spring safety activation mechanism for enhanced patient's comfort

SAFE

- All needles are gamma sterilized and protected with a sterility tab
- Fully enclosed housing ensures that needle is hidden before and after use
- Single-use mechanism prevents sharps injuries and reuse of the device

COMFORTABLE

- Silicone-coated, ultra-thin needles ideally positioned during skin penetration with double-spring mechanism to reduce vibrations
- Color-coded product versions to meet specific blood sample requirements and address a variety of patient skin types
- Ergonomic design for comfortable grip and secure blood collection

SIMPLE

- Easy to use, intuitive operation in 3 steps only, no pre-loading required
- Long safety cap designed for easy removal - simply twist off the cap and pull it out
- Optimal skin contact area for precise positioning on the desired test site and adequate blood flow



**Every product detail
designed with ease of
use and comfort in mind**

ONE-CARETM
PRO

SAFETY LANCETS

INSTRUCTIONS FOR USE

- Intuitive design with only 3 simple steps.
Blood microsampling has never been easier ...

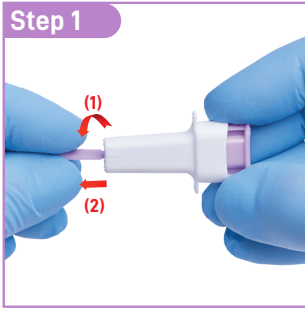

TEST SITE PREPARATION AND SELECTION

Test Sites

Prick the side of the finger, not the pad



- Patient should wash hands with warm water and soap before blood collection
- Test site should be disinfected with alcohol swab
- Blood collection should be performed on the sides of the fingertip, not the pads
- Index, middle and ring fingers are recommended
- Apply intermittent pressure on the finger below test site to enhance blood flow if needed

PRODUCT SELECTION CHART

Available in four color-coded versions to meet different test blood flow requirements and address a variety of patient skin types.

REF.	VERSION	DIAMETER (G) / DEPTH (mm/in)		COLOR	PACKAGING
OCPRO-L100-30	Micro Flow	30G / 1.2 mm			100 pcs/box 2,000 pcs / case
OCPRO-L100-28	Mini Flow	28G / 1.5 mm			100 pcs/box 2,000 pcs / case
OCPRO-L100-25	Low Flow	25G / 1.6 mm			100 pcs/box 2,000 pcs / case



WWW.ONE-CARE.COM



Links Medical Products Inc.®

Contact Us

Links Medical Products Inc. – Corporate Office
9249 Research Drive
Irvine, CA 92618

Email: info@linksmed.com

Phone: 888.425.1149 or 949.753.0001 | Fax: 949.753.7412

www.linksmed.com