

# ONE-CARE<sup>®</sup>

## INSULIN SAFETY SYRINGES

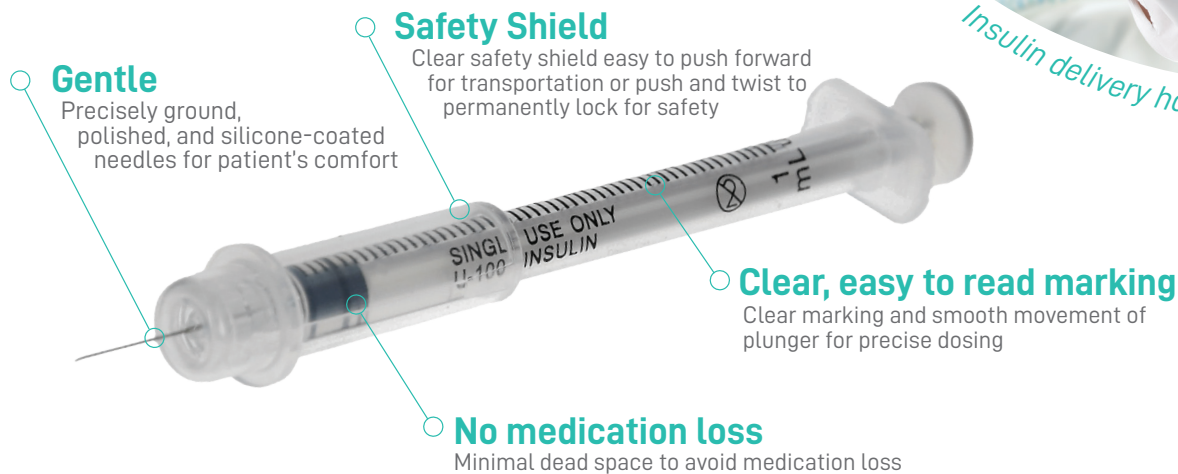

*Insulin delivery has never been easier...*



### Gentle

Precisely ground, polished, and silicone-coated needles for patient's comfort

### Safety Shield

Clear safety shield easy to push forward for transportation or push and twist to permanently lock for safety

### Clear, easy to read marking

Clear marking and smooth movement of plunger for precise dosing

### No medication loss

Minimal dead space to avoid medication loss

## SAFE

- Reliable shielding mechanism for both transportation position and permanent lock
- ETO-Sterilized and protected with color-coded cover and blister pack
- Covering of needle can be done with only one hand by pushing the shield forward towards needle tip to reduce risk of sharps injuries

## SIMPLE

- Easy to use, intuitive operation as per industry standard in Long Term Care facilities
- Safety mechanism engagement indicator via "Click" sound once the shield is pushed forward and turned either direction
- Easy to read marking for precise dosing

## GENTLE

- Precisely ground, electro-polished, silicone-coated, ultra-thin needles on the end of patients comfort
- Smooth and easy movement of plunger for gentle injection

## CONVENIENT

- Minimal dead space to reduce medication loss
- Smart design with temporary needle shielding for transportation and permanent lock after drug delivery to prevent sharps injury and reuse
- Easy to recognize color-coded product versions address a variety of dose requirements

## INSTRUCTIONS FOR USE

■ Intuitive handling with simple steps. Insulin delivery has never been easier...

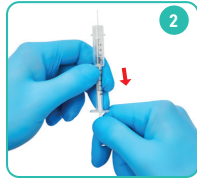
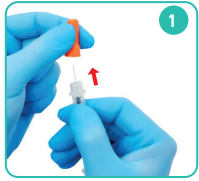

### Remove cover and Draw Up medication

- **Remove** from the blister pack, then take off the color-coded protective cap
- **Draw up** the medication following the established protocol

### Shield for transport and inject

- Slide the safety **shield** over the needle and transport to the injection site
- Before the injection, pull the safety **shield** back uncovering the needle
- Inject the medication

### Lock and Dispose

- When finished, slide the safety shield over the needle until you hear a click and twist the shield (another click) **locking** the needle permanently inside
- Discard the used syringe into a sharps container



Remove the cover



Draw up medicine



Cover for transport



Inject



Shield permanently

## PRODUCT SELECTION CHART

Available in two versions for the right fit for every patient and dose requirement.

ITEM #	SIZE	NEEDLE (DIAMETER x LENGTH)	PACKAGING
OC-ISS100-1.0-29	1 mL	29G x 1/2"   0.3mm x 12.7mm	100 pcs / box 500 pcs / case
OC-ISS100-.5-29	0.5 mL	29G x 1/2"   0.3mm x 12.7mm	100 pcs / box 500 pcs / case



Link Medical Products Inc.®

### Contact Us

Link Medical Products Inc. – Corporate Office  
15979 North 76th Street, Unit D, Scottsdale, AZ 85260 USA

Email: [info@linksmmed.com](mailto:info@linksmmed.com)

Phone: 888.425.1149 or 949.753.0001 | Fax: 949.753.7412

[www.linksmmed.com](http://www.linksmmed.com)